

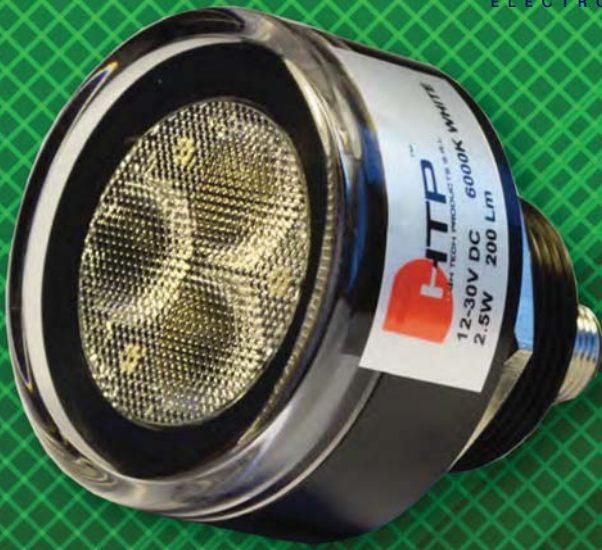

IN2CONNECT
ELECTRONIC CONNECTORS



INDUSTRIAL LIGHTING

INDUSTRIAL LIGHTING

LED LIGHT TUBE:

LED - 12FD - T 1000 12MD

SERIES

LED : LED LAMP.

PLUG TYPE

12FD : M12 PLUG FEMALE.

NO DIGIT : WITH ONLY ONE M12 CONNECTION PLUG.

PROTECTION CLASS

P: IP54. T: IP67.

LED LAMP LENGHT

0250 : 0.25m. 0500 : 0.5m. 1000 : 1m. 2000 : 2m.

PLUG TYPE

12MD : M12 PLUG MALE.

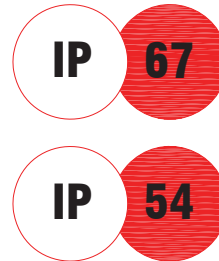

Code	Lighting Length	Rated Voltage	Rated Power	Luminous flux	Lighting colour	Protection class IP	Temperature range °C	No. of FIXING CLIPS	PACKAGING
LED-T0250-12MD	0.25m	24V DC	11 W	550 Lm	6000K Pure White	IP67	-25°C / +60°C	No.2	1piece / box
LED-T0500-12MD	0.5m	24V DC	22 W	1100 Lm	6000K Pure White	IP67	-25°C / +60°C	No.2	1piece / box
LED-T1000-12MD	1m	24V DC	44 W	2200 Lm	6000K Pure White	IP67	-25°C / +60°C	No.2	1piece / box
LED-T2000-12MD	2m	24V DC	88 W	4400 Lm	6000K Pure White	IP67	-25°C / +60°C	No.2	1piece / box
LED-12FD-T0250-12MD	0.25m	24V DC	11 W	550 Lm	6000K Pure White	IP67	-25°C / +60°C	No.2	1piece / box
LED-12FD-T0500-12MD	0.5m	24V DC	22 W	1100 Lm	6000K Pure White	IP67	-25°C / +60°C	No.2	1piece / box
LED-12FD-T1000-12MD	1m	24V DC	44 W	2200 Lm	6000K Pure White	IP67	-25°C / +60°C	No.2	1piece / box
LED-12FD-T2000-12MD	2m	24V DC	88 W	4400 Lm	6000K Pure White	IP67	-25°C / +60°C	No.2	1piece / box



Code	Lighting Length	Rated Voltage	Rated Power	Luminous flux	Lighting colour	Protection class IP	Temperature range °C	No. of FIXING CLIPS	PACKAGING
LED-P0250-12MD	0.25m	24V DC	9 W	450 Lm	4500K Pure White	IP54	-25°C / +60°C	No.2	1piece / box
LED-P0500-12MD	0.5m	24V DC	18 W	900 Lm	4500K Pure White	IP54	-25°C / +60°C	No.3	1piece / box
LED-P1000-12MD	1m	24V DC	36 W	1800 Lm	4500K Pure White	IP54	-25°C / +60°C	No.4	1piece / box
LED-P2000-12MD	2m	24V DC	72 W	3600 Lm	4500K Pure White	IP54	-25°C / +60°C	No.6	1piece / box
LED-12FD-P0250-12MD	0.25m	24V DC	9 W	450 Lm	4500K Pure White	IP54	-25°C / +60°C	No.2	1piece / box
LED-12FD-P0500-12MD	0.5m	24V DC	18 W	900 Lm	4500K Pure White	IP54	-25°C / +60°C	No.3	1piece / box
LED-12FD-P1000-12MD	1m	24V DC	36 W	1800 Lm	4500K Pure White	IP54	-25°C / +60°C	No.4	1piece / box
LED-12FD-P2000-12MD	2m	24V DC	72 W	3600 Lm	4500K Pure White	IP54	-25°C / +60°C	No.6	1piece / box

INDUSTRIAL LIGHTING

LED LIGHT TUBE WITH CABLE:

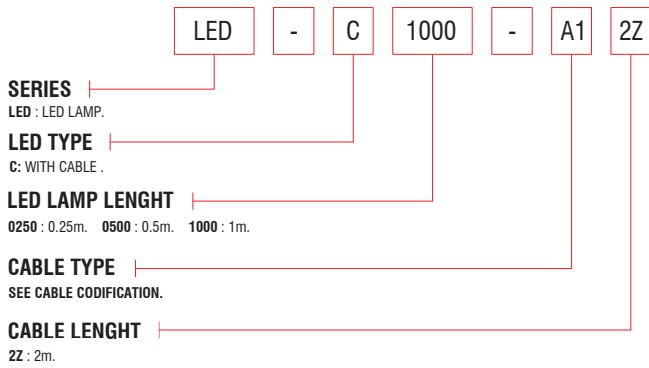

Code	Material	Type of cable	Colour	Section	No.core	Cable ø mm ±0.3	Temperature range °C
C-3-K6-IS	PUR/TPO	ULstyle 21576	Black	0.25mm ²	3	ø 4.1mm	-30°C / +80°C
A1	PVC/PVC	IEC332-1 H03VVF	Black	0.50mm ²	2	ø 5mm	-20°C / +80°C

In2Connect UK Ltd
 Unit L, Tyson Courtyard
 Weldon South Industrial Estate
 Corby
 Northants
 NN18 8AZ
 Tel: 01962 773004
 sales@in2connect.uk.com

TUBULAR LAMPS NOTE:

It is possible to supply tubular lamps with different lengths required by the customer; our tubular lamps are composed of 6 LED segments L ~80mm, therefore you can add or remove 6 LED segments.

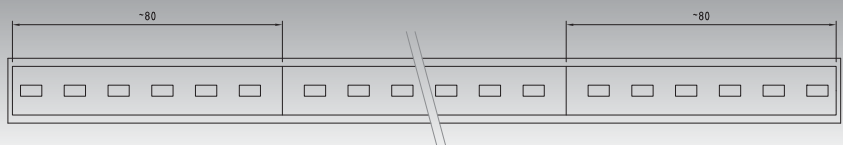

INDUSTRIAL LIGHTING

• GENERAL FEATURES OF INDUSTRIAL CIRCULAR LIGHTING:

Lighting material :
PC Windows.
Alluminium housing.

Fixing system :
M30x1.5 Fixing nut.

Type of terminations :
M12 Male plug.

Max. screw torque IEC60947-1
M12 coupling nut torque 0.4 N*m

M12 material :
Coupling nut: Brass + Nickel plated.
Internal core: PA66.
Contacts: Brass + Gold flash.

Protection class :
IP 67.

Storage temperature :
-40°C +70°C
-20°C +50°C HUMIDITY 90%

Rated current:
12/18 V : 0.208A
24 V : 0.104A
30/36 V : 0.83A

Operating voltage:
ø 50mm : 12-30 V DC
ø 64mm : 16-36 V DC

Rated Power:
ø 50mm : 2.5 W
ø 64mm : 4.2 W

Light colour:
6000K Cool White.

Lumens(25°C):
ø 50mm : 200Lm
ø 64mm : 330Lm

Life Time:
After 50000 hour light decay less than 30%.

Packaging:
1piece / box.

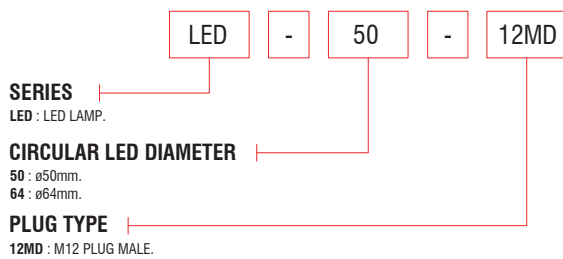

LED-50-12MD

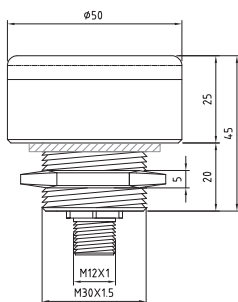

LED-64-12MD

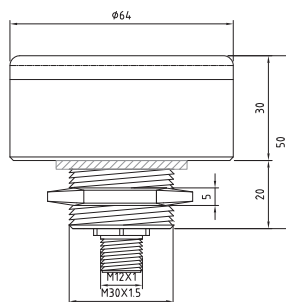

LED-50-12MD



LED-64-12MD

• ACCESSORIES:



Code	Description	Cable length	PACKAGING
LED-PS-EU-12FD	Feeder EUROPEAN connection + M12 female connetor	1.8m	1piece / box
LED-PS-USA-12FD	Feeder AMERICAN connection + M12 female connetor	1.8m	1piece / box