

PUSHBUTTON SWITCHES



IN2CONNECT
ELECTRONIC CONNECTORS

Series 48-SS



ACTUAL SIZE

12MM MINIATURE HALL-EFFECT SEALED

This rugged sealed pushbutton switch uses a Hall-Effect sensor to achieve extremely long life, up to 1,000,000 cycles momentary. This switch is suited for harsh environments where long life and reliability are needed.

APPLICATIONS:

- Communications
- Data entry
- Hand-held control modules
- Outdoor controls
- Mass transport controls
- Instrumentation

KEY FEATURES:

- 1,000,000 cycles momentary
- Momentary and maintained action
- Hall-Effect technology
- Choice of LED colors (or non-lighted versions)
- Panel sealed to IP67
- Variety of Button colors
- Square and round versions available
- Solder, PC terminals or Wireleads

In2Connect UK Ltd

Unit L, Tyson Courtyard

Weldon South Industrial Estate

Corby

Northants

NN18 8AZ UK

Tel: 01962 773004

sales@in2connect.uk.com

ORDERING INFORMATION:

Module Type:	Switch Function:	Switch Termination:	Bezel Type:	Led [#] Color:	Button [@] Color:	Mounting Type:	Voltage Resistor:
48-3	Momentary	Solder Tabs	RB Round, Black	N None	(H)RD Red (for High Button)	B Bushing	If Blank*
48-4	Maintained	Solder Tabs	SB Square, Black	R Red	(H)GR Green (for High Button)	S Snap-fit	05 5V Forward
48-7	Momentary	PC		G Green	(H)BK Black (for High Button)		
48-8	Maintained	PC		Y Yellow	(H)BL Blue (for High Button)		
48-C	Momentary	Wire Leads		A Amber	(H)YL Yellow (for High Button)		
48-D	Maintained	Wire Leads		B Blue	(H)OR Orange (for High Button)		
				W White	(H)WH White (for High Button)		
				RB Red / Blue	PK Black with Standby Symbol		
				RG Red / Green			

Lighted switches come with wires on LEDs to protect from solder heat.

* Current limiting resistor is required to limit LED forward current to 20 mA (not included).

@ H_ _ only for High Button type.

STANDARDS / AGENCY / RATINGS:



SERIES 48: 12MM MINIATURE HALL-EFFECT SEALED

PRODUCT DRAWINGS

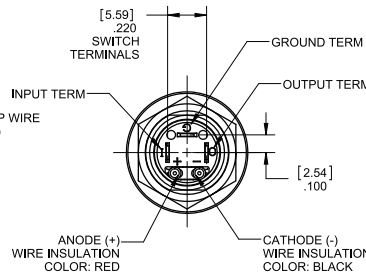
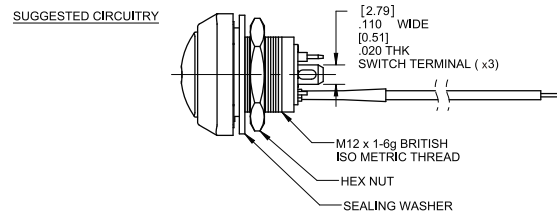
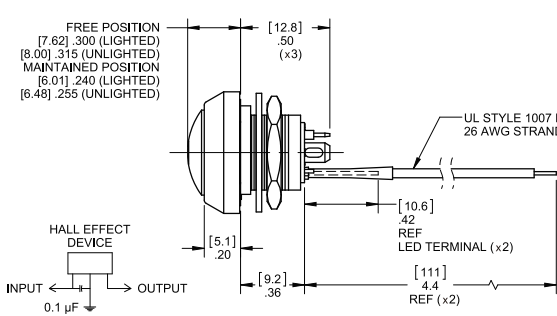
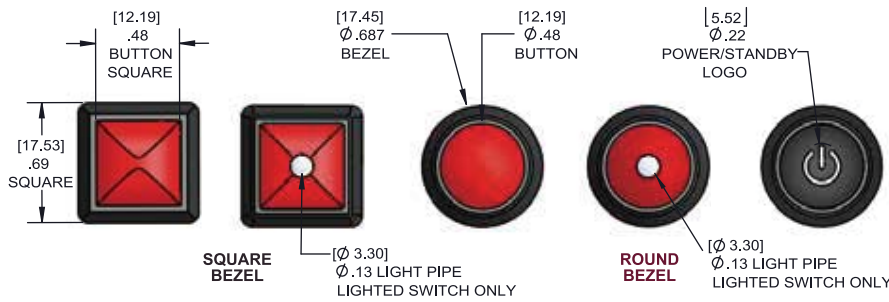

SNAP-FIT

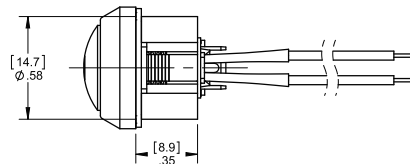
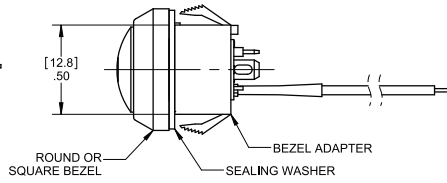

WIRELEAD

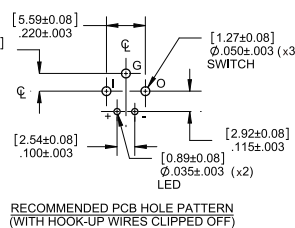
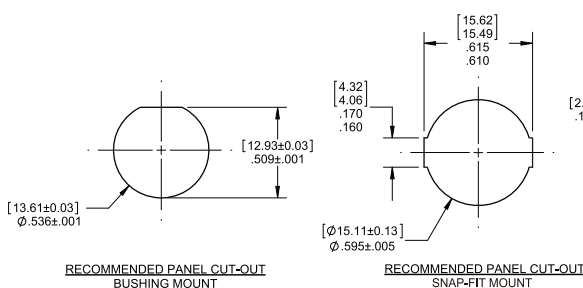
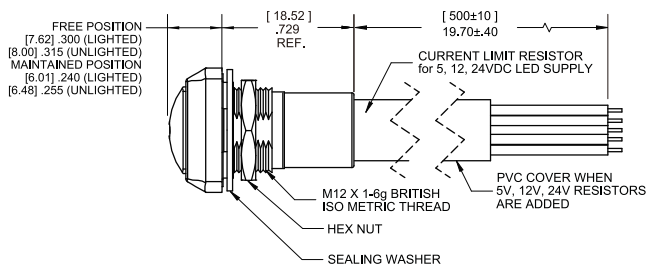
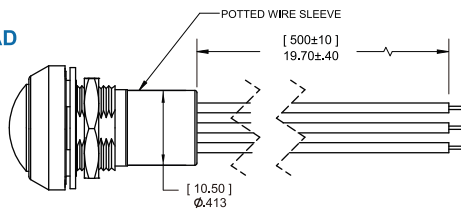

MECHANICAL CHARACTERISTICS

- CIRCUIT:** SPST-NO-DB (FORM X)
- BUTTON TRAVEL (NOM):** [2.3] .09
- OPERATING FORCE (NOM):** [3N] 306g
- PANEL THICKNESS:** BUSHING MOUNTING: [0.5-3.0] .02-.12
- SNAP-FIT MOUNTING: [1.3-3.0] .05-.12

- NUT TORQUE (MAX):** [11.5 kgf/cm] 10 lb/in
- HARDWARE** BUSHING MOUNTING BULK PACKAGED SEALING WASHER AND HEX NUT ARE INCLUDED.

ENVIRONMENTAL SPECIFICATIONS

- ACTUATOR INGRESS PROTECTION:** IP67
- OPERATING TEMPERATURE:** [-40°C to +85°C] -40°F to +185°F

ELECTRICAL SPECIFICATIONS

- SUPPLY VOLTAGE:** 4.2V TO 24V, 26.5 MAX
- SUPPLY CURRENT:** B>Brp, Vcc=12V: 3mA TYP to 8mA MAX
B>Bop, Vcc=12V: 4mA TYP to 8mA MAX
- OUTPUT LOAD:** SINKING (I out MAX = 25mA)
- REVERSE BATTERY VOLTAGE:** -30V MAX
- REVERSE OUTPUT CURRENT:** -50mA MAX
- SWITCH LIFE:** MOMENTARY: 1,000,000 CYCLES
MAINTAINED: 50,000 CYCLES

- WIRE LEADS:** UL STYLE 1007 26 AWG, STRANDED