

THTR

by ept

The new THTR hm 2.0 mm connectors.

Peiting: ept is saving customers time and manufacturing costs by offering the new THTR hm 2.0 mm Hard Metric female connector. In addition to the standard press-fit right angle female connectors, ept now offers a paste in hole re-flow hm 2.0 mm right angle female connector.

Until recently the only means of applying a right angle female connector was to "Press-fit" the connector to the PCB after all components had been placed and reflow soldered. Press-fit is no longer the only means to apply hm 2.0 mm connectors to a PCB. The new THTR connectors, (Through-Hole Technology Reflow) offered by ept, can be fitted to the PCB with all other SMT components prior to reflow, thus eliminating the Press-fit step.

The connector is manufactured with a high-temp plastic and can be soldered in a paste in hole process with all other surface mount components. The design of the wafers has been optimized to ensure the best possible convection for the re-flow process. This all means less time, fewer production steps, and lower overall costs. The mating end of the connector is the same superior ept female design with "flexible zone" dual beam contacts.

The connectors are available in our full female hm 2.0 mm Hard Metric product range for the type A, B, C and AB modules with or without ground shields.

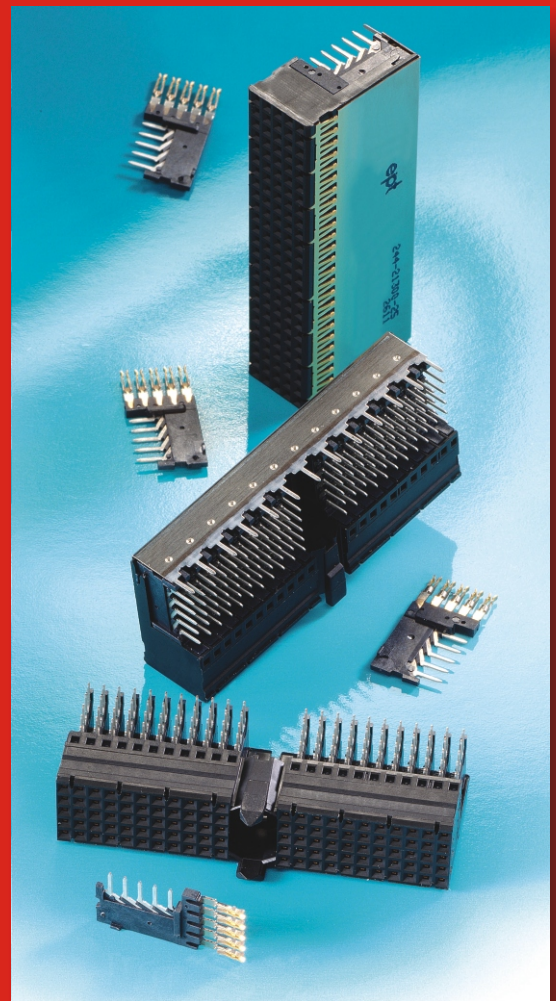

This is the ept advantage. The better connection!

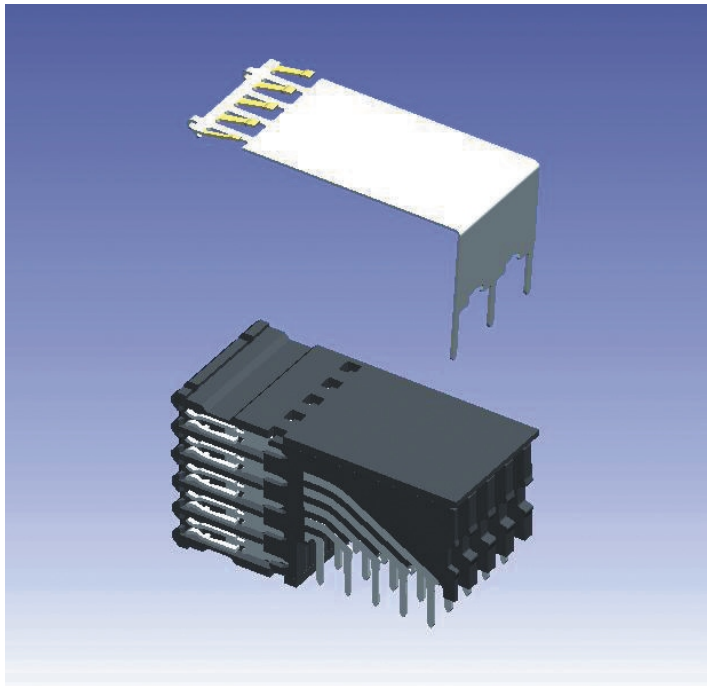

Electro mechanic data

Type		A, B, C, AB
Shielding		upper shield
Pitch		2 mm
Mechanical Life Cycle		> 250 insertion cycles
Insulator		heat resistant
Contact		bronze
Isolation Resistance	contact/ contact	min. 10 ⁴ M0hm
	contact/ shielded	min. 10 ⁴ M0hm
PCB layout		

ept GmbH & Co. KG

Bergwerkstraße 50
D-86971 Peiting

Tel.: +49(0)8861-25 01-0
Fax: +49(0)8861-55 07
E-mail: sales@ept.de

In2Connect

Tel: +44 (0)1962 733337
Fax: +44 (0)1962 736726
in2connect@beeb.net
<www.in2connect.co.uk>